

POWER ELECTRONICS

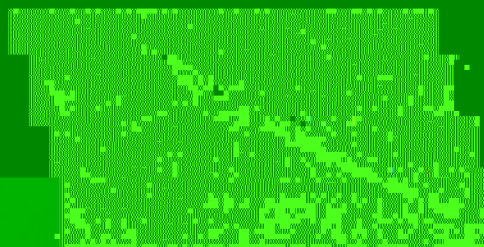

■ DC/DC converter (power factor correction) for a laser system (laser diode) - power factor correction

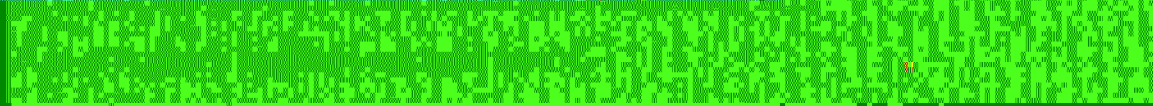
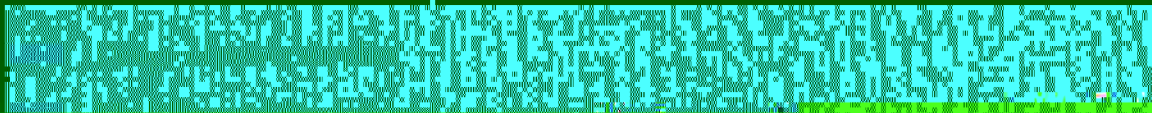
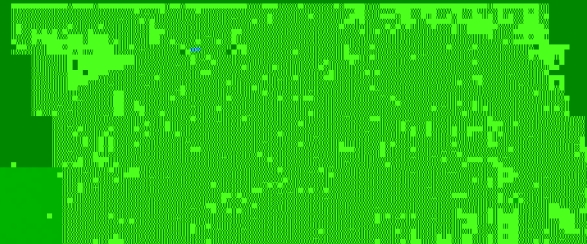

■ AC/AC inverter (three-phase inverter) with digital control for implementation of a motor drive

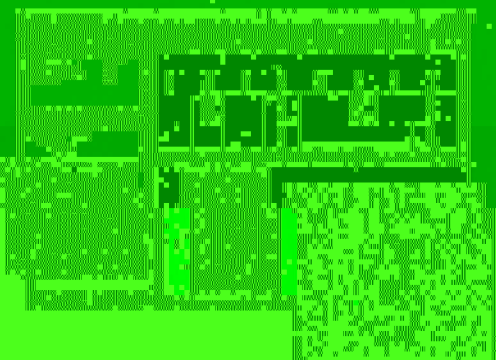

■ DC/DC converter (DC/DC inverter) used in the design of a motor drive

■ Modeling and design of electronic systems and components (power components, AC/DC, DC/DC, AC/AC, etc.)

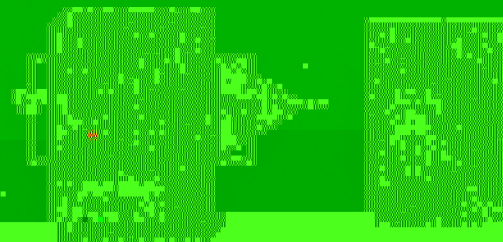

■ Modeling and design of electronic systems (DC/DC inverter) used as a multi-phase inverter with multi-bridge

